

- LIST FOR POSSIBLE TANDEM UNITS:**
- | | |
|-----------|-----------|
| 101 & 102 | 103 & 104 |
| 109 & 110 | 105 & 106 |
| 111 & 112 | 107 & 108 |
| 119 & 120 | 114 & 115 |

NOTE:
Standard company policy regarding request for tandem shall apply.

**GROUND FLOOR PLAN
BUILDING H - ZEPHYR
APRIL 2024
PER MEMO REF. # DE-24-04-008**



NOTED BY:	AUDREY	
	ALDRICH	
	ANA	



Disclaimer: Floor plans depicted in this material are for demonstration purposes only and should not be relied upon as final project plans. For announcement purposes only.

AVAILABILITY PLAN

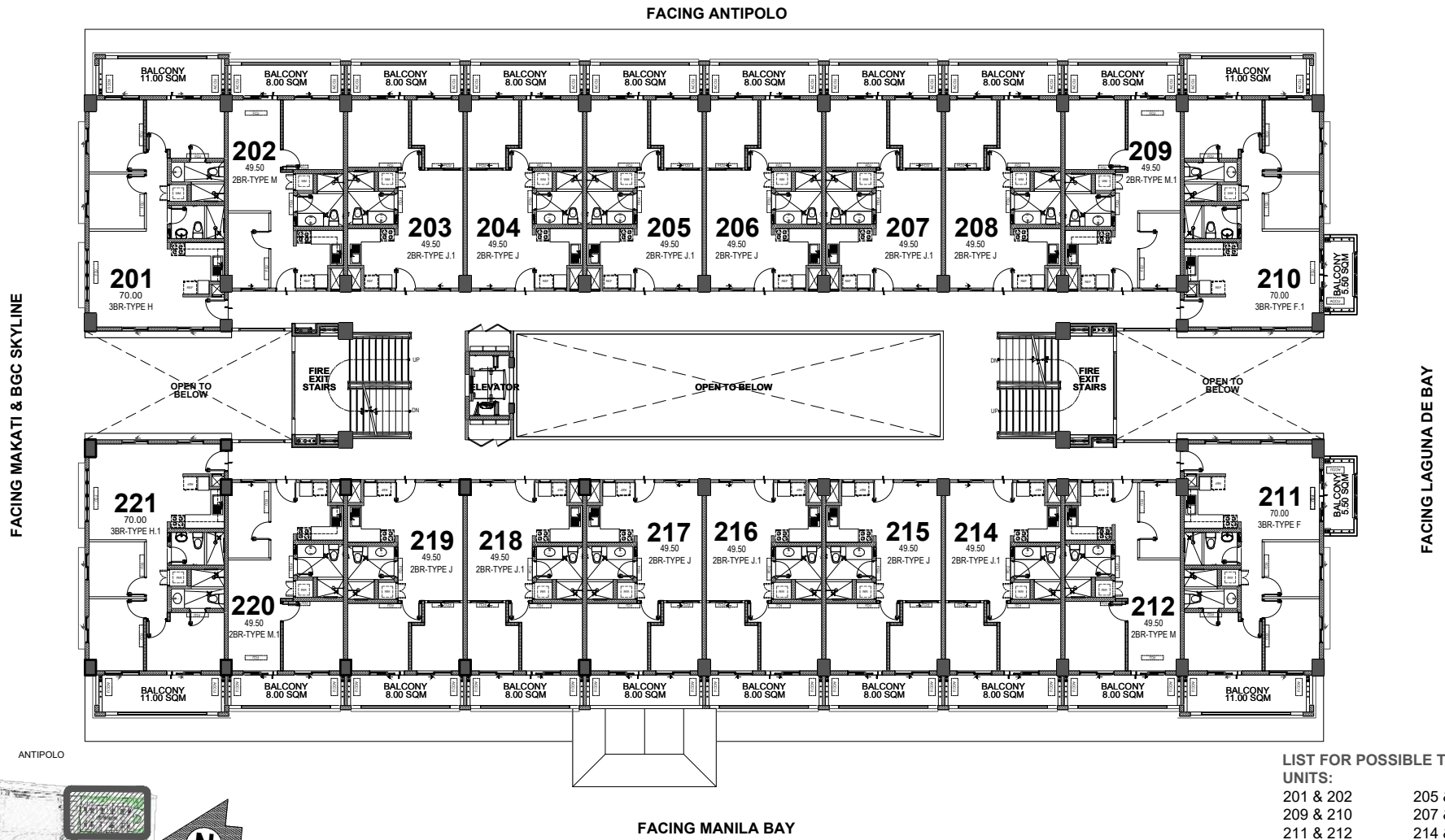

- LIST FOR POSSIBLE TANDEM UNITS:**
- | | |
|-----------|-----------|
| 201 & 202 | 205 & 206 |
| 209 & 210 | 207 & 208 |
| 211 & 212 | 214 & 215 |
| 220 & 221 | 216 & 217 |
| 203 & 204 | 218 & 219 |

NOTE:
Standard company policy regarding request for tandem shall apply.



**2ND FLOOR PLAN
BUILDING H - ZEPHYR
APRIL 2024
PER MEMO REF. # DE-24-04-008**



NOTED BY:	AUDREY	
	ALDRICH	
	ANA	



Disclaimer: Floor plans depicted in this material are for demonstration purposes only and should not be relied upon as final project plans. For announcement purposes only.

AVAILABILITY PLAN

FACING ANTIPOLO

FACING MAKATI & BGC SKYLINE

FACING LAGUNA DE BAY

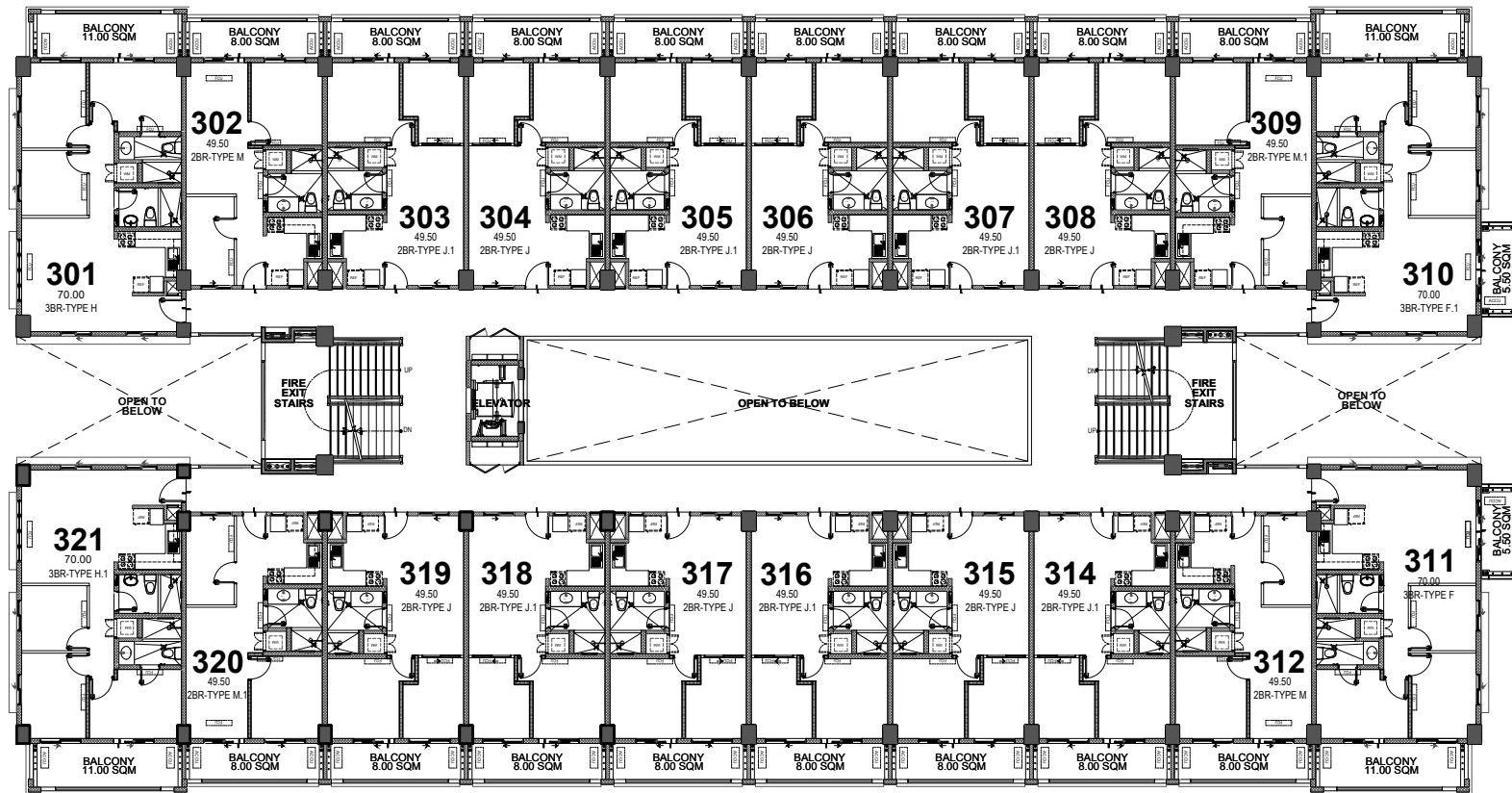

ANTIPOLO

FACING MANILA BAY

MAKATI & BGC SKYLINE



LAGUNA DE BAY

MANILA BAY

LIST FOR POSSIBLE TANDEM UNITS:

- | | |
|-----------|-----------|
| 301 & 302 | 305 & 306 |
| 309 & 310 | 307 & 308 |
| 311 & 312 | 314 & 315 |
| 320 & 321 | 316 & 317 |
| 303 & 304 | 318 & 319 |

NOTE:
Standard company policy regarding request for tandem shall apply.

**3RD FLOOR PLAN
BUILDING H - ZEPHYR
APRIL 2024
PER MEMO REF. # DE-24-04-008**



NOTED BY:	AUDREY	
	ALDRICH	
	ANA	



Disclaimer: Floor plans depicted in this material are for demonstration purposes only and should not be relied upon as final project plans. For announcement purposes only.

AVAILABILITY PLAN

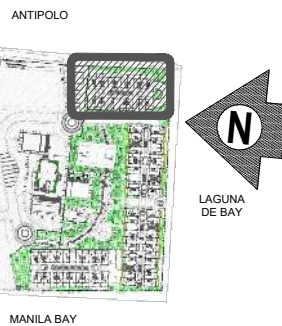
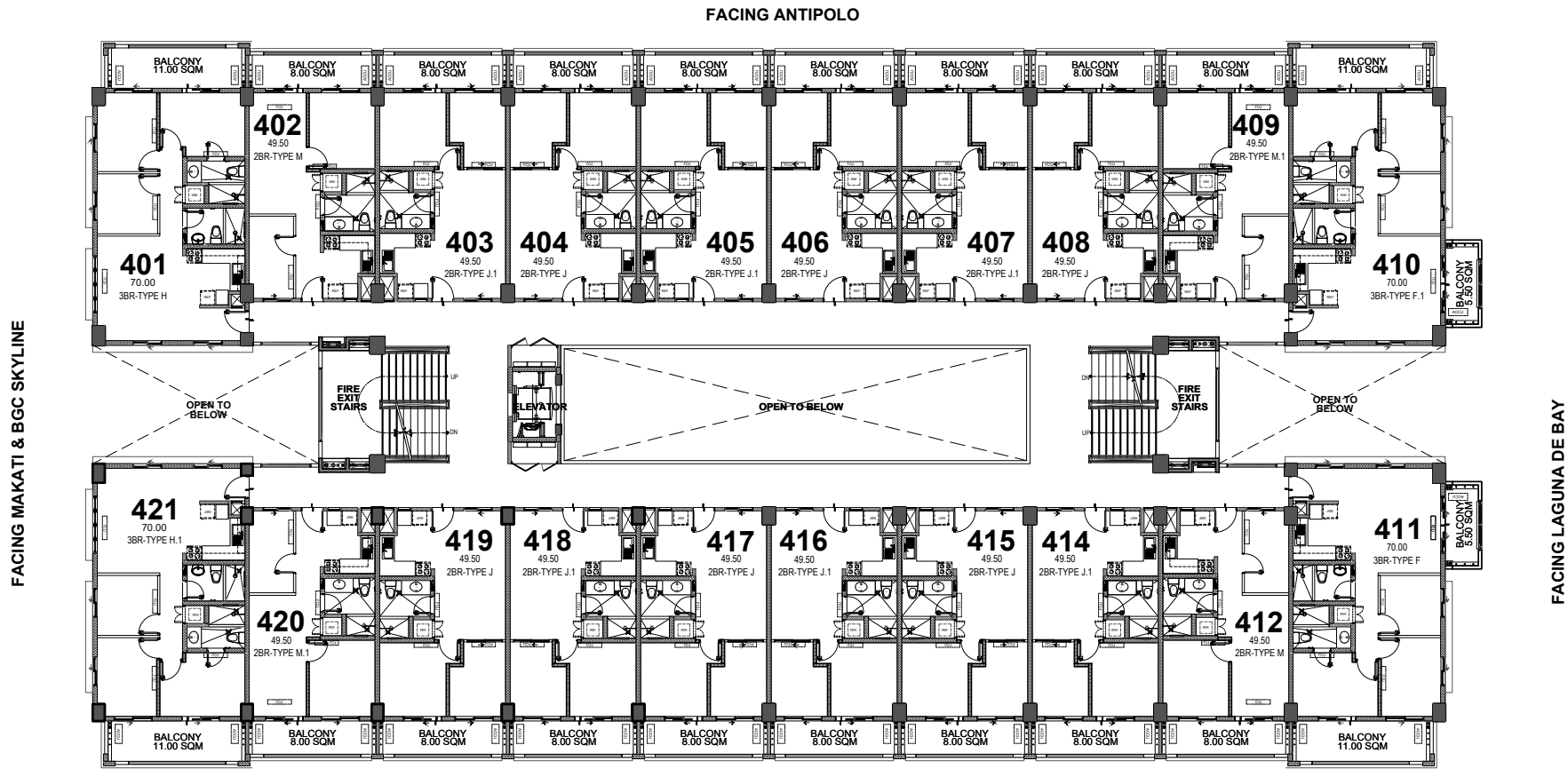

FACING MANILA BAY

4TH FLOOR PLAN
BUILDING H - ZEPHYR
APRIL 2024
PER MEMO REF. # DE-24-04-008

- LIST FOR POSSIBLE TANDEM UNITS:**
- | | |
|-----------|-----------|
| 401 & 402 | 405 & 406 |
| 409 & 410 | 407 & 408 |
| 411 & 412 | 414 & 415 |
| 420 & 421 | 416 & 417 |
| 403 & 404 | 418 & 419 |

NOTE:
 Standard company policy regarding request for tandem shall apply.

DMCI HOMES <small>Focus real good to be home.</small>	NOTED BY -	AUDREY	
		ALDRICH	
		ANA	



Disclaimer: Floor plans depicted in this material are for demonstration purposes only and should not be relied upon as final project plans. For announcement purposes only.

AVAILABILITY PLAN

FACING ANTIPOLO

FACING MAKATI & BGC SKYLINE

FACING LAGUNA DE BAY

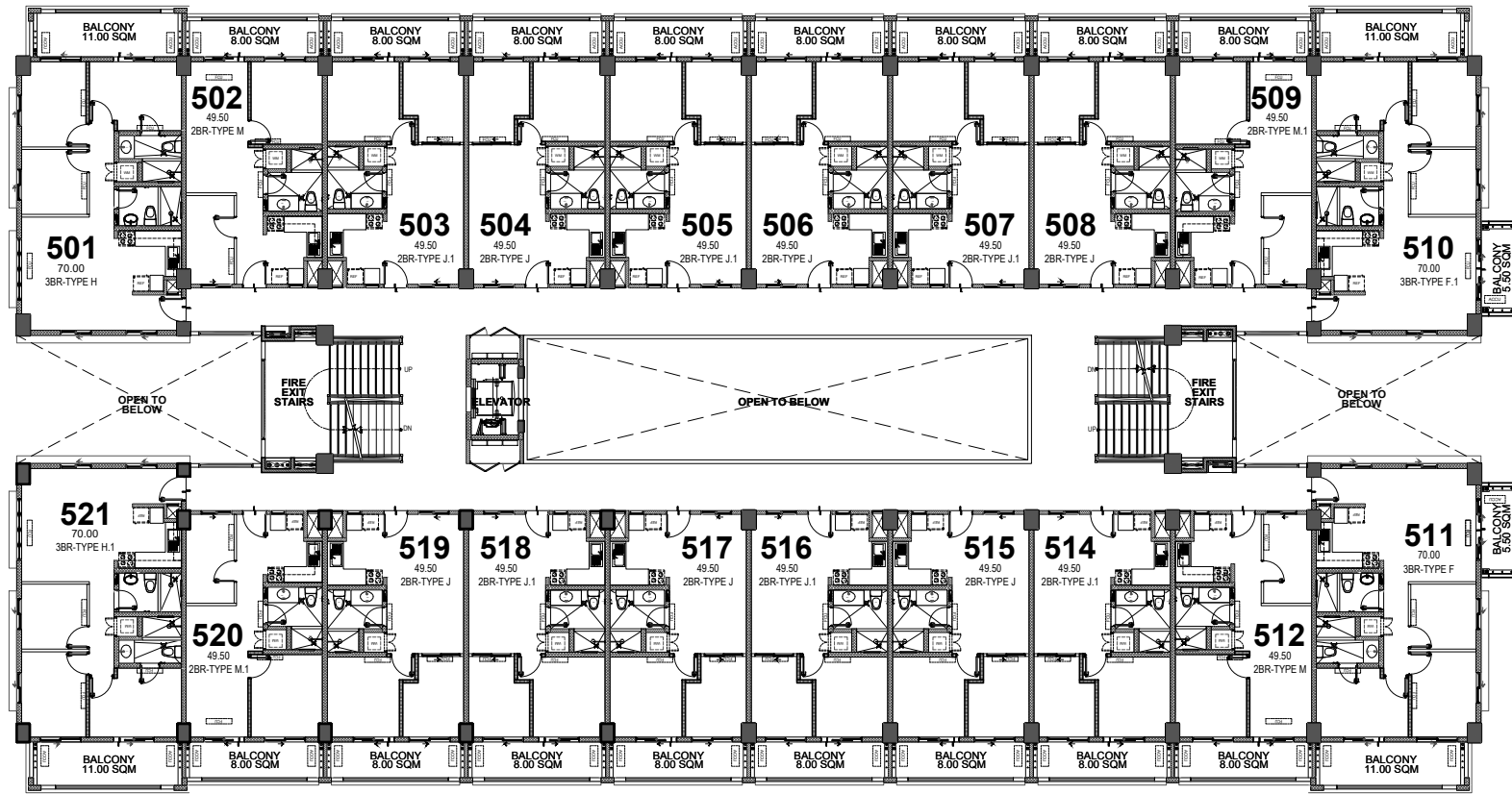

ANTIPOLO

FACING MANILA BAY

5TH FLOOR PLAN
 BUILDING H - ZEPHYR
 APRIL 2024
 PER MEMO REF. # DE-24-04-008

LIST FOR POSSIBLE TANDEM

- UNITS:
- | | |
|-----------|-----------|
| 501 & 502 | 507 & 508 |
| 509 & 510 | 514 & 515 |
| 511 & 512 | 516 & 517 |
| 520 & 521 | 518 & 519 |

NOTE:
 Standard company policy regarding request for tandem shall apply.

MAKATI & BGC SKYLINE



LAGUNA DE BAY

MANILA BAY



NOTED BY:	AUDREY	
	ALDRICH	
	ANA	



Disclaimer: Floor plans depicted in this material are for demonstration purposes only and should not be relied upon as final project plans. For announcement purposes only.

AVAILABILITY PLAN

FACING ANTIPOLO

FACING MAKATI & BGC SKYLINE

FACING LAGUNA DE BAY

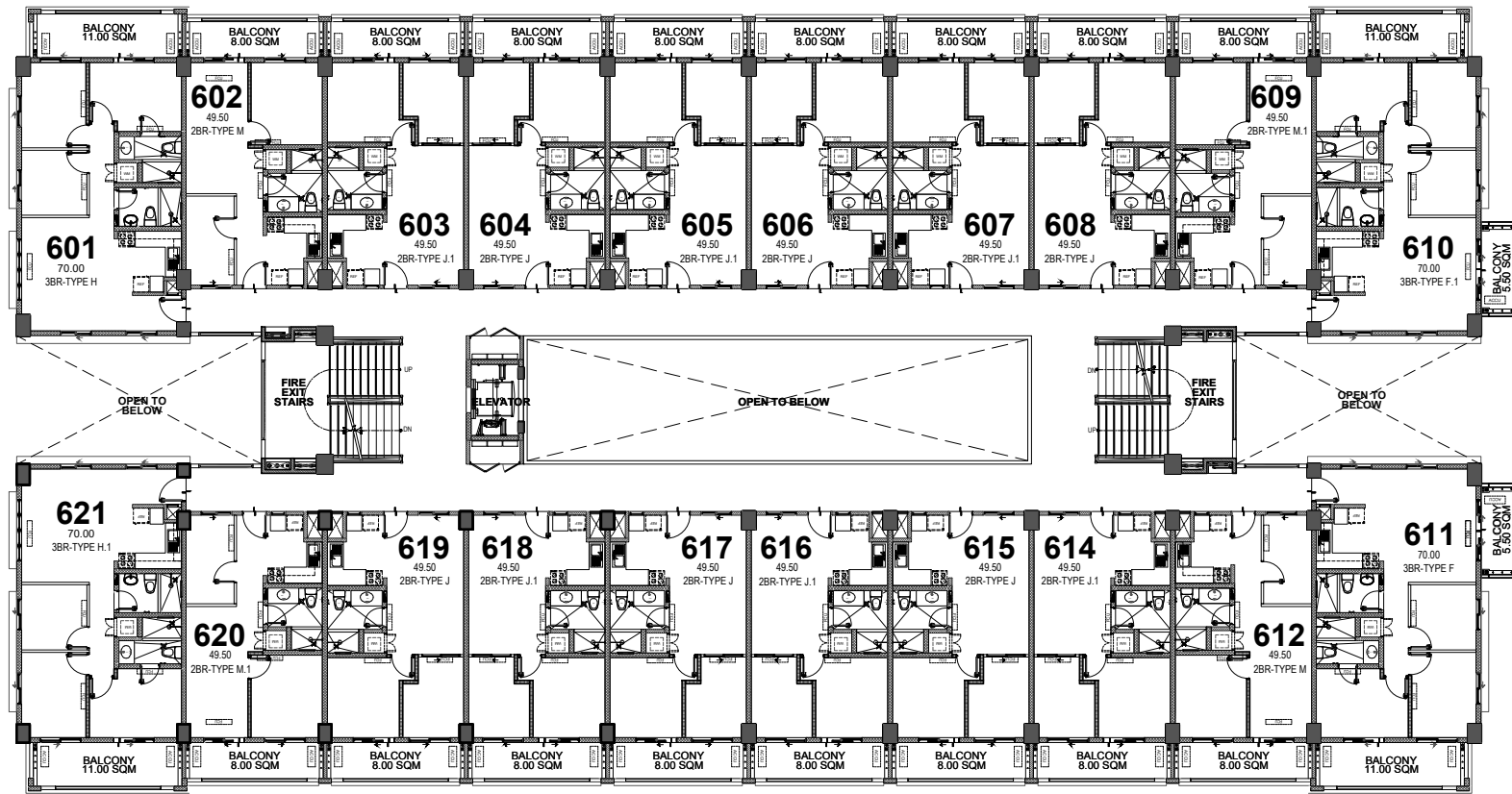

ANTIPOLO

FACING MANILA BAY

MAKATI & BGC SKYLINE



LACUNA DE BAY

MANILA BAY

LIST FOR POSSIBLE TANDEM

- UNITS:**
 601 & 602 603 & 604
 609 & 610 607 & 608
 611 & 612 614 & 615
 620 & 621 618 & 619

NOTE:
 Standard company policy regarding request for tandem shall apply.

6TH FLOOR PLAN
BUILDING H - ZEPHYR
APRIL 2024
PER MEMO REF. # DE-24-04-008



NOTED BY:	AUDREY	
	ALDRICH	
	ANA	



Disclaimer: Floor plans depicted in this material are for demonstration purposes only and should not be relied upon as final project plans. For announcement purposes only.

AVAILABILITY PLAN

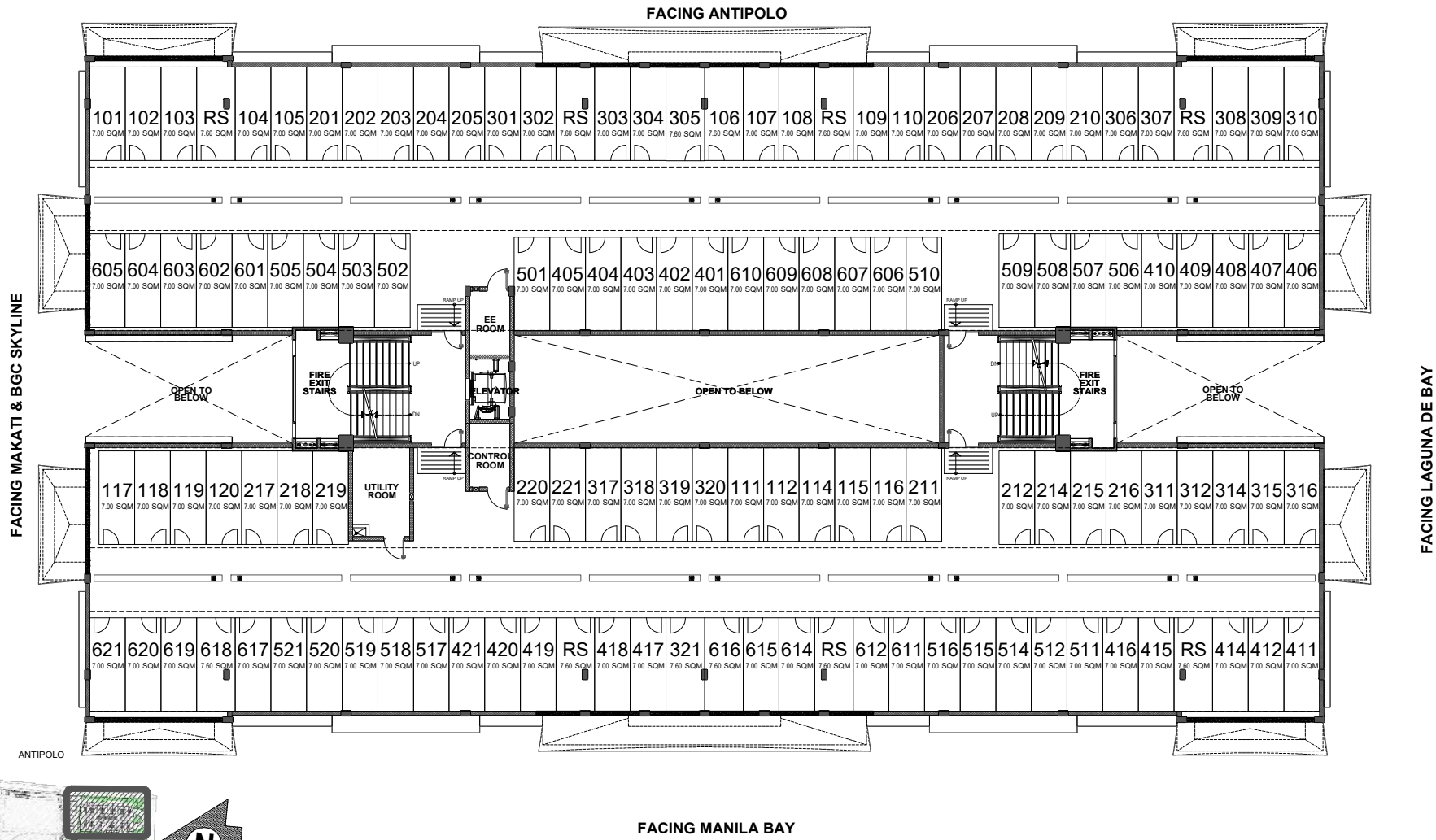

ROOF DECK FLOOR PLAN
BUILDING H - ZEPHYR
 APRIL 2024
 PER MEMO REF. # DE-24-04-008

	NOTED BY -	AUDREY	
		ALDRICH	
		ANA	



Disclaimer: Floor plans depicted in this material are for demonstration purposes only and should not be relied upon as final project plans. For announcement purposes only.

AVAILABILITY PLAN

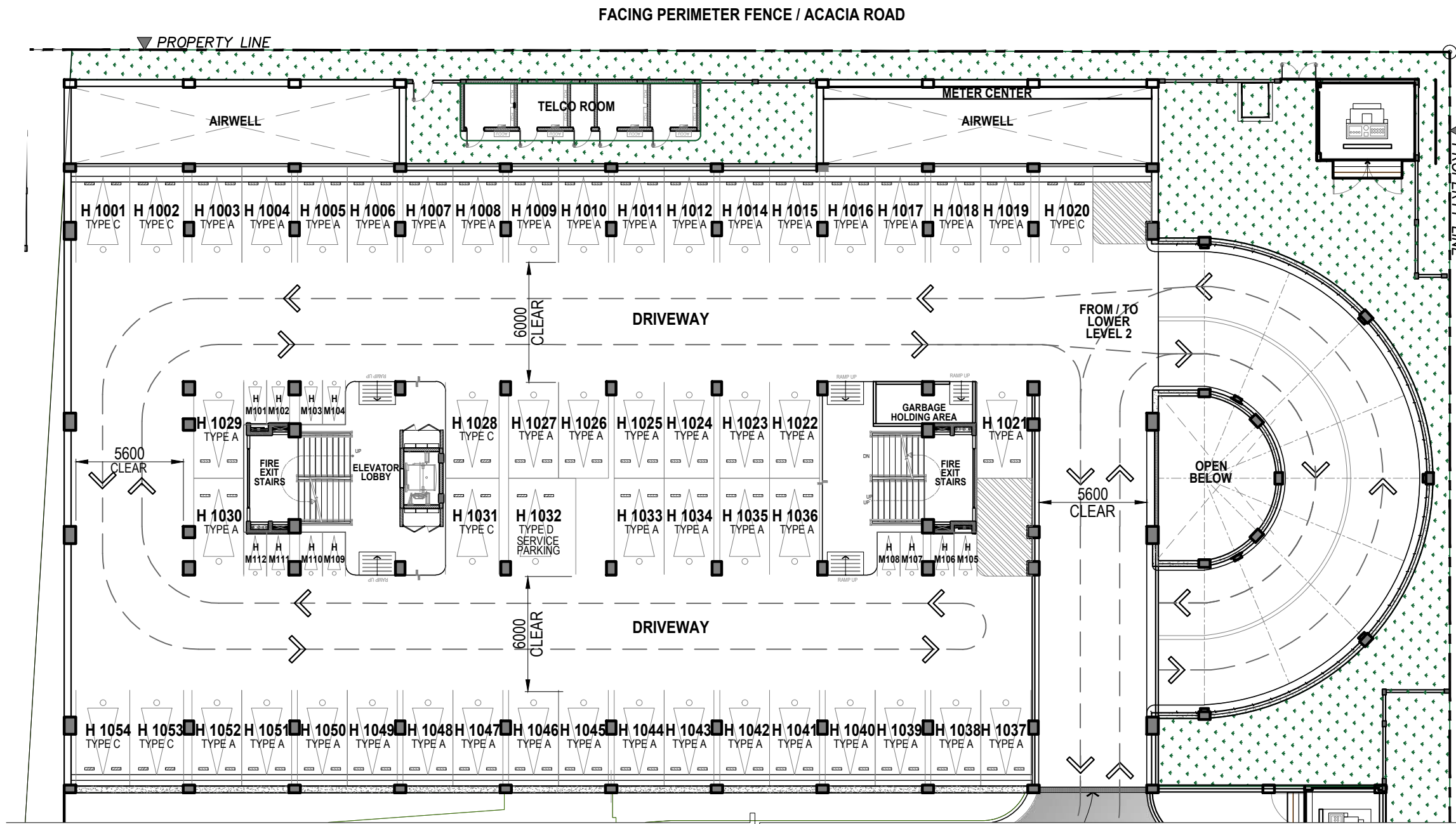

FACING BUILDING A - BENGALINE / GUARDHOUSE

FACING PERIMETER FENCE / ACACIA TOWN CENTER

FACING PERIMETER FENCE / ACACIA ROAD

PROPERTY LINE

PROPERTY LINE

FACING SPLIT PARKING G / BUILDING G-TAFETTA

FROM / TO MAIN ROTUNDA OR TAFETTA

PARKING SLOTS - LOWER LEVEL 1			
TYPE	DIMENSION	AREA	QTY.
TYPE A	2.60 X 5.00	13.00	45
TYPE C	2.80 X 5.00	14.00	7
TYPE D	3.50 X 5.00	17.50	1
TOTAL			53
MOTORCYCLE	1.20 X 2.30	2.76	12

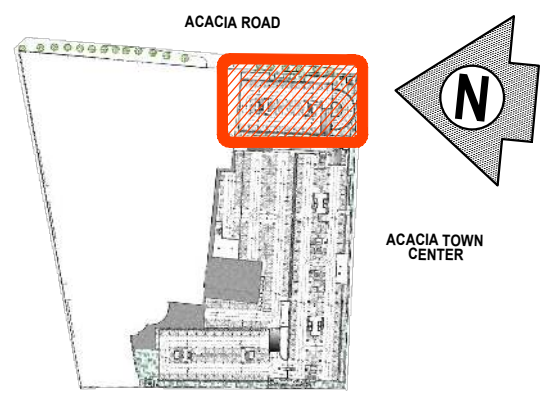

LOWER LEVEL 1 FLOOR PLAN
 BUILDING H - ZEPHYR
 MARCH 2025
 PER MEMO REF. # DE-25-03-004



NOTED BY:	Signature	Date
AUDREY	<i>[Signature]</i>	03/14/25
ALDRICH	<i>[Signature]</i>	14-Mar-25
ANA	<i>[Signature]</i>	3/17



Disclaimer: Floor plans depicted in this material are for demonstration purposes only and should not be relied upon as final project plans. For announcement purposes only.

AVAILABILITY PLAN

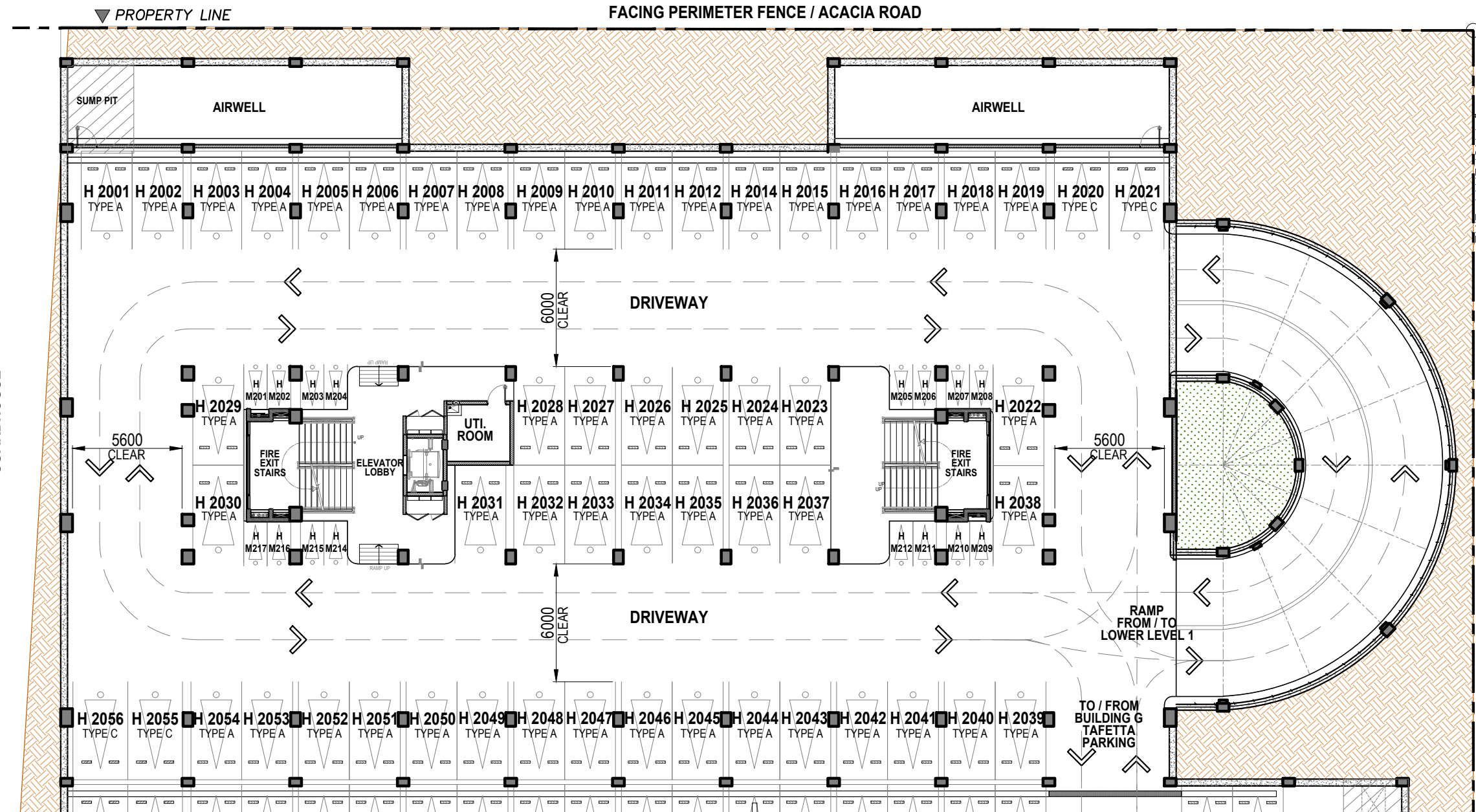

FACING BUILDING A - BENGALINE / GUARDHOUSE

FACING PERIMETER FENCE / ACACIA TOWN CENTER

FACING PERIMETER FENCE / ACACIA ROAD

PROPERTY LINE

PROPERTY LINE

FACING SPLIT PARKING G / BUILDING G-TAFETTA

PARKING SLOTS - LOWER LEVEL 2			
TYPE	DIMENSION	AREA	QTY.
TYPE A	2.60 X 5.00	13.00	51
TYPE C	2.80 X 5.00	14.00	4
TOTAL			55
MOTORCYCLE	1.20 X 2.30	2.75	16

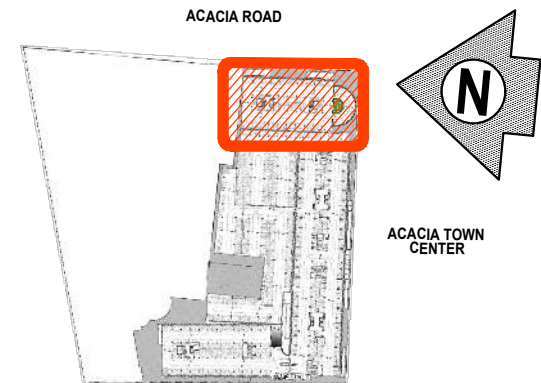

LOWER LEVEL 2 FLOOR PLAN
 BUILDING H - ZEPHYR
 MARCH 2025
 PER MEMO REF. # DE-25-03-004

	NOTED BY: AUDREY	<i>[Signature]</i>	03/14/25
	ALDRICH	<i>[Signature]</i>	14-Mar-25
	ANA	<i>[Signature]</i>	3/17



Disclaimer: Floor plans depicted in this material are for demonstration purposes only and should not be relied upon as final project plans. For announcement purposes only.

AVAILABILITY PLAN